



GRANDE PRAIRIE

**Alliance Church**

## COMMUNITY CARE PASTOR

---

**JOB TITLE:** Community Care Pastor

**REPORTS TO:** Executive Pastor to the Lead Pastor

**POSITION STATUS:** Permanent Full-Time (40hrs/week)

### **POSITION PURPOSE:**

The Community Care Pastor nurtures the spiritual and emotional well-being of the church by fostering a caring, Christ-like community. This role guides members in discipleship, provides compassionate pastoral care, oversees membership and baptisms, supports marriage and funeral services, and facilitates life groups. Ultimately, the Community Care Pastor serves as a bridge between the church and its members, creating an inclusive and supportive environment where everyone can grow and feel cared for. This position requires a compassionate, empathetic individual who can offer support, guidance, and comfort to our members during times of joy, sorrow, and every moment in between. This role also requires the ability to create, develop, and support a team to achieve this work across various ministry areas.

### **KEY AREAS OF RESPONSIBILITY:**

#### ▪ **DISCIPLESHIP PROCESS**

- Take the existing discipleship efforts and formalize them into a unified, easy-to-follow pathway that clearly communicates next steps for spiritual growth. This pathway should help adults discover their spiritual gifts, connect them to ministry, and help support them in their faith journey.
- Equip and train lay leaders to operate as discipleship mentors and guides to others within the congregation.
- Monitor and evaluate the effectiveness of discipleship initiatives and adjust accordingly.
- Develop a clear vision for adult ministries, collaborating with other church staff and leadership teams to intentionally integrate adult ministries within the strategic plan of the church.
- Unite all aspects of our adult discipleship process so that we learn to abide in Jesus, flourish in a life of worship with Him, be connected and committed to the body of Christ, understand and use our God-given gifts in service to one another, to the church, to the community, and abroad, and ensure they are equipped to actively share Jesus with others.
- Evaluate the effectiveness of our current spiritual gifts and ministry alignment system designed to equip congregants, including lay leaders, to discover their spiritual gifts, calling, interests, and availability for ministry. Refine and enhance the process and compile a Spiritual Gift Inventory to better connect individuals to ministry opportunities.

#### ▪ **PASTORAL CARE**

- Provide holistic pastoral care and emotional support to individuals and families during times of crisis, illness or transition, including but not limited to, emotional and social support, crisis intervention, bereavement support, guidance and counselling, healing and reconciling, and helping individuals build resilience, find hope and purpose within the community of GPAC.
- Provide pastoral care and support for congregants, including home visits, hospital visits, people in crisis (including Faith In Deed clients), family care, weddings, and funerals.
- Recruit, train, and support teams involved in adult ministries, including but not limited to life groups, the seniors' Chapel Service, Young At Heart 2.0 group.
- Addressing spiritual needs, offering guidance and mentorship to help individuals connect with their faith.

▪ **MAJOR LIFE EVENTS (BIRTHS, MARRIAGE & MEMBERSHIP & BAPTISM, FUNERALS)**

- Provide pre-marital counselling and support to engaged couples.
- Offer grief counselling and support to families during times of loss.
- Be the point person for coordinating funeral arrangements and liaising with the funeral homes of Grande Prairie.
- Oversee the membership process, including new member orientation and integration into the church community.
- Prepare candidates for baptism, overseeing the event process and baptism classes/conversations as required.

▪ **LIFE GROUPS**

- Encourage and support the formation and growth of life groups within the church.
- Work closely with First Impressions leadership and teams to guide newcomers through the Connections Pathway.
- Train and equip life group leaders to foster community and spiritual growth.
- Facilitate communication and resource sharing among life groups.
- Organize events and activities that promote life group engagement.
- Provide oversight, guidance, and support to adult ministry groups.

▪ **Supervisory/Leadership Responsibilities**

- Participate in weekend services as required.
- Oversee, equip, empower, and evaluate adult ministry teams.

**QUALIFICATIONS:**

- Possesses recognized spiritual gifts in shepherding and leadership, evidenced through effective ministry and team guidance.
- Exhibits agility and composure in adapting to dynamic situations, with a proven eagerness to learn and grow in real-time ministry contexts.
- Demonstrates a strong track record of managing and resolving conflicts across diverse gender and age groups.
- Excels in interpersonal and communication skills, actively listening, articulating ideas clearly, and fostering collaborative relationships.
- Makes compassionate, approachable, and spiritually mature decisions, consistently modelling Christ-like character.
- Has a confirmed ability to form, develop, and empower ministry teams for impactful service.
- Committed to ongoing personal and professional growth, consistently seeking opportunities to learn and develop.
- Brings extensive pastoral ministry experience, grounded in strong biblical knowledge and a steadfast commitment to The Alliance Canada's Statement of Faith and Call to Excellence
- Eligible for accreditation with the Christian and Missionary Alliance denomination in Canada.
- Candidates must be legally eligible to work in Canada before being hired

**What will help you thrive:**

- Skilled at helping others express their emotions and concerns by actively listening and empathizing with their experiences and perspectives.
- Takes initiative as a self-starter, consistently demonstrating the ability to anticipate needs and solve problems proactively.
- Shows aptitude for developing leaders and fostering a sense of community by gathering people together.
- Recent experience in leading or participating in a community group is preferred.
- Demonstrates the ability to prioritize tasks and collaborate effectively within a multi-person office environment.
- Brings an outgoing personality, thriving in roles that require frequent conversations and interactions with congregants and volunteers.

# WHY



## Grande Prairie Alliance Church?

We are a growing church of over 1,000 people, located between Whispering Ridge and Westlake subdivisions, uniquely positioned to serve our neighbours, city, and region. Rooted in strong family values and a passion to Make Jesus Known, we celebrate what God is doing locally and globally. Led by the Holy Spirit, we're committed to building a welcoming community where faith grows, relationships deepen, and lives are changed.

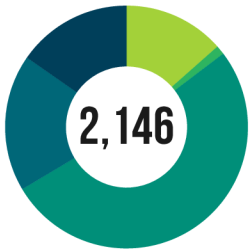
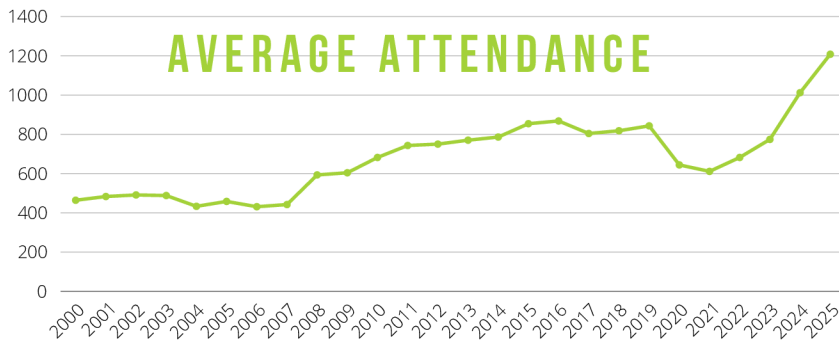

**280 MEMBERS**  
**25 ASSOCIATE MEMBERS**  
**1,144 ADHERENTS**  
**379 AGES 0-11**  
**318 AGES 12-17**



**61 BAPTISMS  
LAST YEAR**

September 1, 2023 to August 31, 2024



Grande Prairie is the largest city north of Edmonton. Located in the Peace Region, it's a growing, youthful city.

As a regional centre, it serves more than 281,000 people across Northern Alberta, BC, and NWT. Its diverse economy is rooted in oil and gas, forestry, agriculture, and retail.

## Make Jesus KNOWN

Our mission is to lead people to become fully devoted followers of Christ.

People who are fully devoted are:

- Discipled to abide in Jesus and flourish in a life of worship of Him.
- Connected and committed to the body of Christ.
- Empowered to clearly understand their spiritual gifts and find places to use them.
- Equipped to actively share their faith with all people who don't know Jesus locally and globally.

**73,942 SQ. FT** Total Building Square Footage

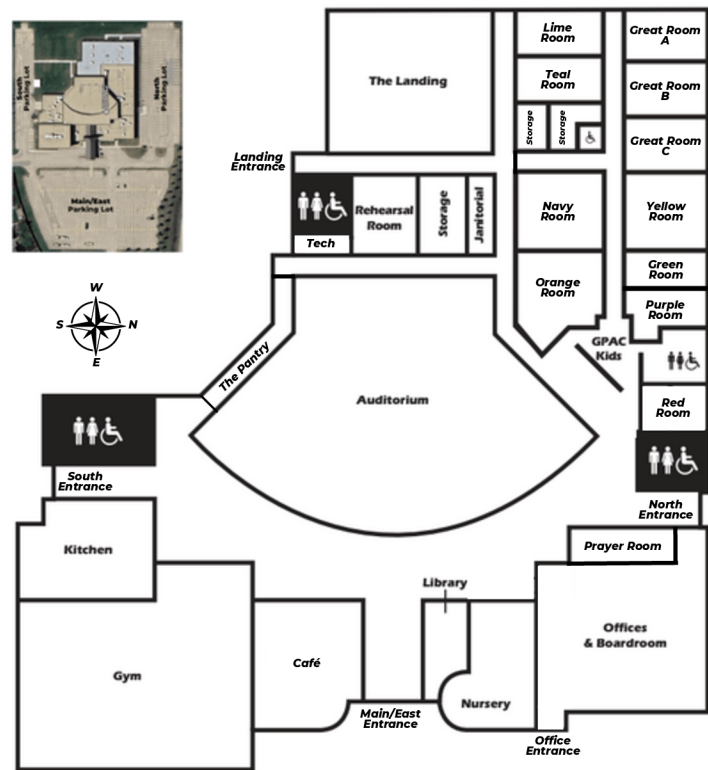

**POPULATION**  
**68,350**

2022 Stats. Can. Estimate

Several smaller communities bring



The median age of the community is a youthful 34.6  
 National Average: 41.6

**73.4%** POPULATION INCREASE 2001-2021

**2.79%** POPULATION GROWTH RATE 2001-2021

**5.65%** UNEMPLOYMENT RATE (2023 AVERAGE)